

Door chain lockable TK 50



For entrance doors to houses and flat apartments

Door leaf/ door frame do not need to be drilled

Silver

Hardened door chain - length: 290 mm

Chain holder for door handle



ORIGINAL INSTALLATION INSTRUCTIONS



facebook.com/BASIGmbH



[@basi_gmbh](https://www.instagram.com/basi_gmbh)



www.basi.eu

General notes

Intended use

The door chain provides additional protection against unauthorised intrusion in the rooms.

The ideal level of protection can only be achieved if you follow these assembly instructions.

Follow the instructions in this manual on how to mount the additional lock correctly. Keep the assembly instructions in a safe place in case you need to remove or replace the additional lock.



Warnings: No hazards are to be expected if the installation is carried out in a professional manner

and in accordance with the instructions. Small parts and packaging materials can be swallowed by children and lead to choking! Make sure that small parts and packaging materials do not get into the hands of children. Dispose of the packaging material immediately.

The TK 50 door chain protects your house and apartment front doors against unauthorised intrusions. It can be assembled without any significant visual disturbance. The chain is simply placed over the door handle or doorknob for protection.

- Easy to assemble: door leaf or door frame does not have to be drilled.
- Easy to handle: The chain holder only needs to be placed over the door handle.
- Lockability: The chain is secured with a lock to prevent it from being pulled out of the holder.

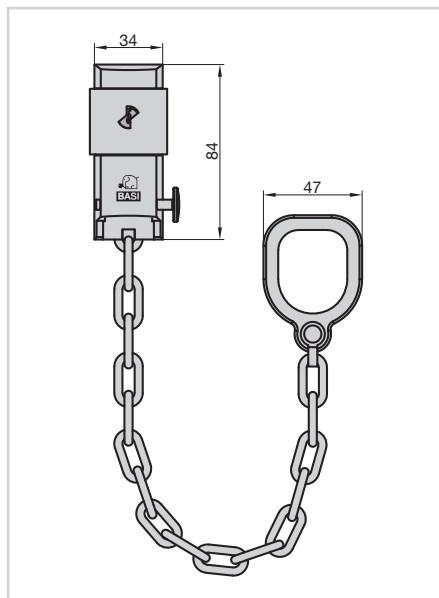

Disclaimer

The manufacturer accepts no liability for damage and/or injury resulting from improper handling and/or assembly of the product or use of the required tools. When using power tools (e.g. drills), ensure that you adhere to all safety instructions provided by the manufacturer of the respective tool.

Scope of delivery

Check that the delivery is complete:

- 1x bottom installation base (1)
- 1x lock housing (2)
- 1x cylinder housing (3)
- 1x housing cover (4)
- 1x threaded screw M3 x 75 mm (5)
- 1x grub screw (6)
- 1x door chain with locking bolt (7)
- 1x retaining pin (8)
- 4x screws M5x 35 mm (9)
- 4x dowels (10)

Required tools

- (Phillips) screwdriver
- Allen key for grub screw
- Drill with matching bit (6 mm)
- Tape measure
- Marker pen, scribing needle or similar

General installation tips

- Make sure before assembly that the door can be opened and closed flawlessly.
- While drilling, pay attention that you do not damage any moving parts.
- Use a drill stop to ensure that the length of the dowel as well as the screws used are appropriate.
- Tighten the mounting screws by hand with a suitable screwdriver to avoid over-twisting.

Installation steps

1. Remove the thread screw (5) to dismantle the lock unit of the door chain holder (consisting of the lower assembly base (1), lock housing (2), cylinder housing (3) and housing cover (4) .
2. Select the assembly position of the lock unit.

Hold the lower assembly base (1) in the appropriate position and mark the two drill holes.

3. Then drill both holes with a 6 mm bit, insert two dowels (10) and fasten the assembly base (1) with two screws (9)
4. Place the lock housing (2) on the assembly base (1) and mark the two drill holes.
5. Drill the holes, insert the remaining two dowels (10) and fasten the lock housing (2) with the two screws (9).
6. Insert the cylinder housing (3) from above and fit the housing cover (4).
7. Using the thread screw (5), screw the lock housing back onto the housing cover (4).
8. Insert the retaining pin (8) for the chain holder into the lock housing (2) so that the knob of the pin points towards the door. Bring the retaining pin (8) into the latching position and secure it with the grub screw (6).
9. Engage the door chain with the locking bolt (7) in the lock housing.
10. Place the door chain with the throw ring over the retaining pin (8).

Technical specifications

Area of application	for entrance doors to houses and flat apartments
Material	Hardened chain links
Chain length	approx. 290 mm
Diameter of chain holder	outside: 47 mm, inside approx. 40 mm
Colour	Silver

Operation

- If you wish to open the door, place the chain holder on the chain retainer or disengage the chain.
- If you wish to secure the door, place the chain holder on the door handle or the doorknob.
- The door can now be opened only slightly. If you want to avoid the chain being disengaged, be sure to lock the door chain holder.

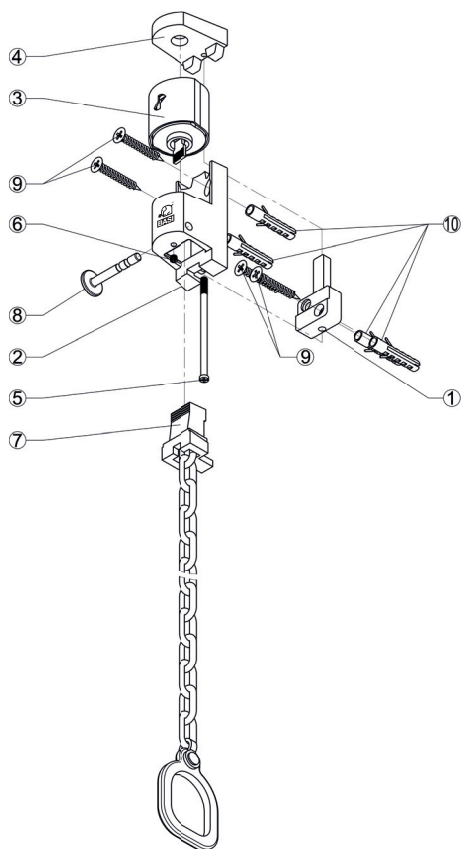
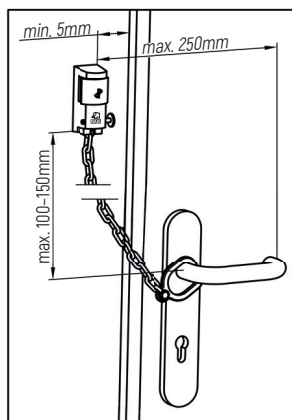

Lock unit

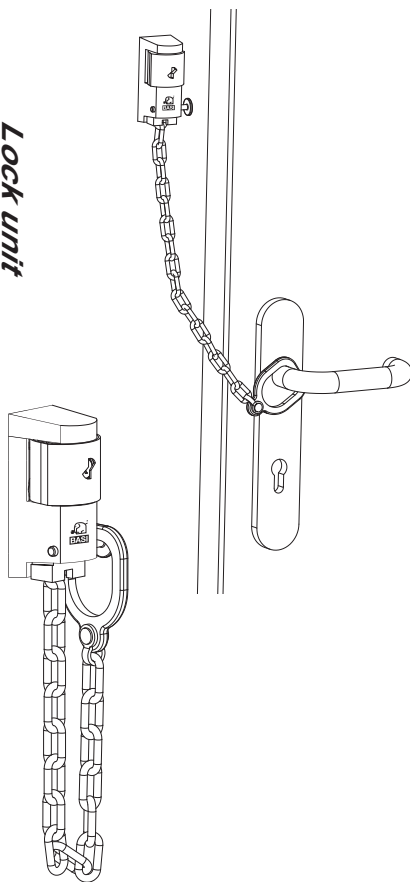

Cleaning/maintenance

Minor contaminations on the door chain TK 50 can be removed with a damp cloth.



Disposal

Help to protect the environment and dispose of the product and the packaging materials in accordance with the local regulations.

© Copyright

Reprinting or reproduction (even excerpts thereof) is forbidden without approval of:
BASI GmbH
Konstantinstraße 387
41238 Mönchengladbach
Germany

2024

This publication, including all its parts, is protected by copyright.

The use of any material exceeding the strict boundaries of copyright law without the consent of BASI GmbH is prohibited and punishable by law.

This applies specifically to reproductions, translations, microfilming and the feeding and processing in electronic systems.

BASI GmbH
Konstantinstraße 387
41238 Mönchengladbach
Germany